

# AL DRIVER 400™

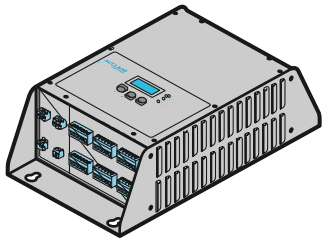

Client:

Project:



Type:

Order Code:

Quantity:

The **AL Driver 400** is a multi-protocol, 400W driver for low voltage LED products. The input control protocols include DMX, RDM, 0-10V and DALI; and features 24V DC / PWM output. It offers maximum flexibility with your front end control preferences.

## SPECIFICATIONS

Input Voltage	100-277VAC, 50/60Hz
Output Voltage	24VDC
DC Output Wattage	400W
DC Output Current	6.6A maximum per channel
Control Input Protocols	DMX+RDM, 0-10V (sink and source), DALI
Control Output Protocols	Multi-channel PWM
Maximum Power Consumption	480W
Optional Operating Modes	Static color selection, internal preset color fade
Internal Sensors	Temperature & usage, data accessible via the on-board display
Finish	Black
IP Rating	IP22, Dry Location
Ambient Operating Temperature	14° F to 113° (-10° C to 45° C)
Connectors	6 pin terminals for PWM outputs, 3 pin terminals for DMX, 2 pin terminals for 0-10V & DALI
Warranty	5 Years Limited
Weight	8.4 lbs. (3.8 kg)
Dimensions	<b>L:</b> 13.4" <b>W:</b> 9.06" <b>H:</b> 3.15" (L: 340mm W: 230mm H: 80mm)
Certifications	 

## ORDER CODE

### ALD424

## WIRING

### AC Power Input: 100-277VAC, 50/60Hz

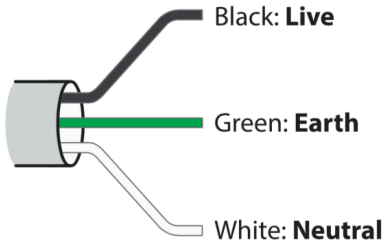

### DMX In / Out

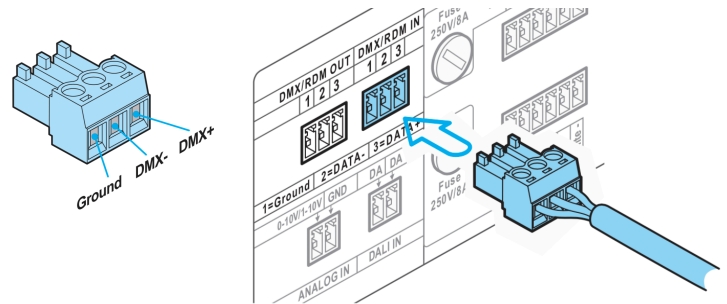

### DALI Input

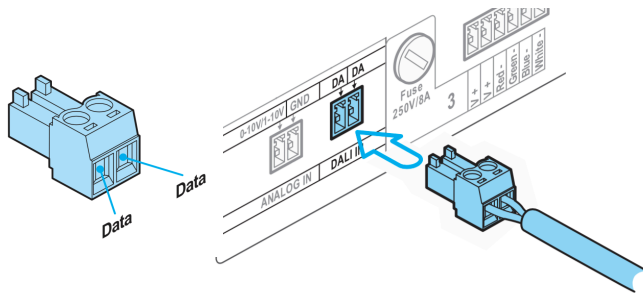

### 0-10V Input

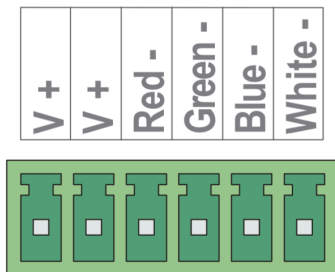
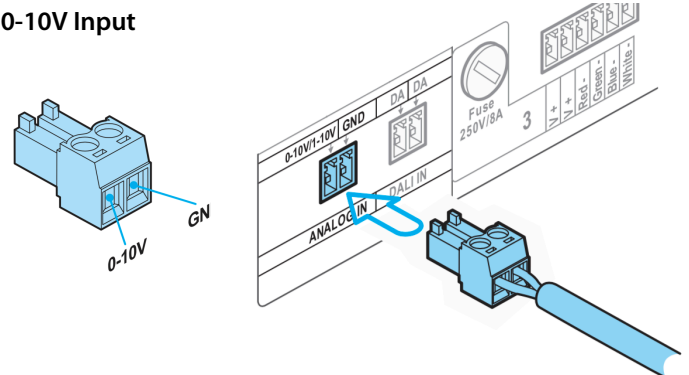

LOAD = RGB	V+	V+	Red	Green	Blue	
LOAD = RGBW	V+	V+	Red	Green	Blue	White
LOAD = Ai Dim	V+	V+	W1	W2	W3	W4
LOAD = DW	V+	V+	Warm	Cold	Warm	Cold
LOAD = White	V+	V+	White	White	White	White

#### Notes:

- Whichever LOAD-type is chosen, that setting will be applied globally to all ports. For example, it is not possible to choose Ai Dim operation for some ports and RGBW for others.
- The maximum **6.6A** load limit for each port (and the maximum overall load for the whole device) must not be exceeded.
- In Ai Dim mode, the W1 to W4 connections align with the four marked wires of products such as Ai Flex.

## DIMENSIONS

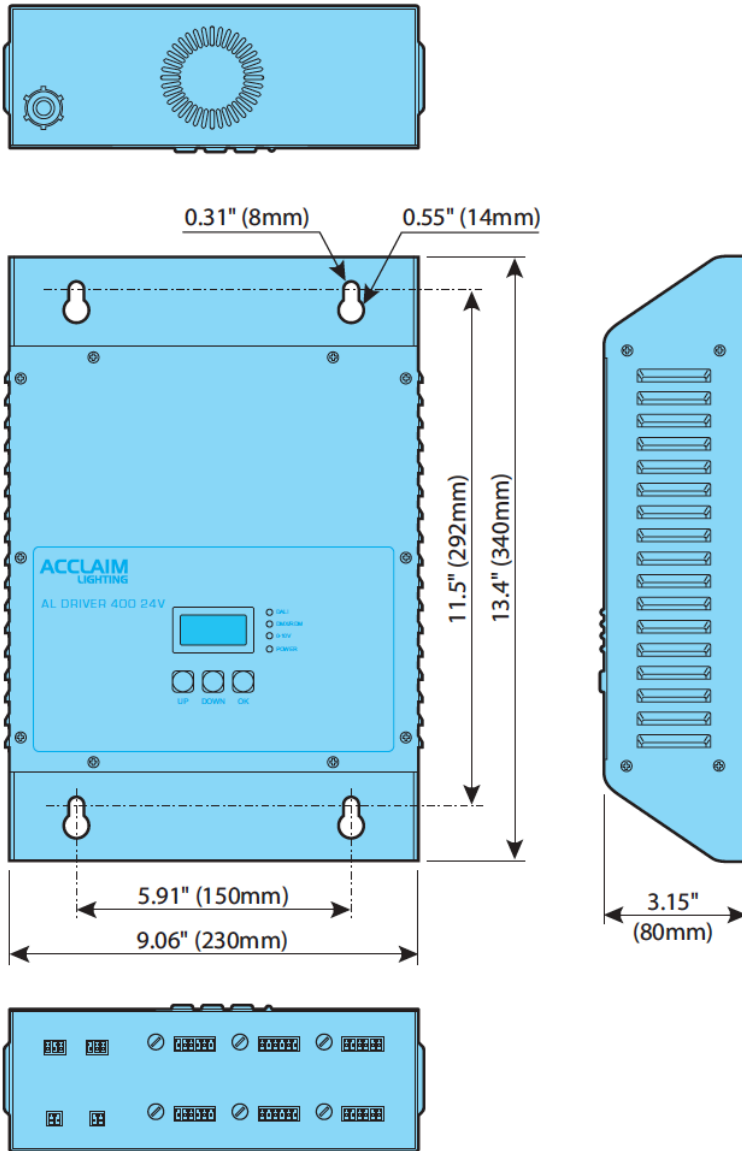

Weight: 8.4 lbs (3.8kg)